

**OCCHIELLI INOX TESTA PIATTA – INOX FLAT HEAD EYELETS –  
 OEILLETS INOX TÊTE PLATTE**



Edizione 2020

Composizione articoli / item composition

1.0	Occhiello + rondella / Eyelet + washer Oeillet + Rondella (OC+RA)
2.1	Occhiello / eyelet / Oeillet (OC)
2.2	Rondella / washer / Rondelle (RA)

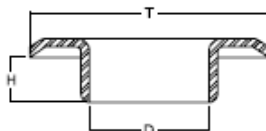

2.1



2.2

**DIMENSIONI / SIZES / DIMENSIONS:** mm

**PESO / WEIGHT / POIDS:** gr / 1000 pcs ("W" indica il peso nominale, il peso reale può essere differente / "W" stays for the standard weight; the real weight can be different / «W» indique le poids nominal, le poids réel peut être différent.

**MATERIALE / MATERIAL / MATERIAL:** inox aisi 304 – stainless steel aisi 304 – acier inoxydable aisi 304

**OCCHIELLI INOX TESTA PIATTA – INOX FLAT HEAD EYELETS –  
 OEILLET INOX TÊTE PLATTE**

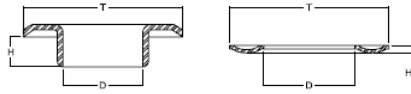

1.0 Occhiello + rondella / Eyelet + washer /  
 Oeillet + rondelle (OC+RA)

2.1 Occhiello / eyelet / oeillet (OC)

2.2 Rondella / Washer / Rondelle (RA)

		D (mm)	T (mm)	H (mm)	W (g)	COD.	Note
1.0	OC + RA 230TP				520		
2.1	OC 230TP	5,0	12,0	4,0	330	IOCP05120530	
2.2	RA R230S	5,0	12,0	0,9	190	IRAS06120830	

		D (mm)	T (mm)	H (mm)	W (g)	COD.	Note
1.0	OC + RA 30TP				910		
2.1	OC 30TP	7,9	15,0	5,0	670	IOCP08150635	
2.2	RA R30	8,3	14,6	0,8	240	IRAN10150830	

		D (mm)	T (mm)	H (mm)	W (g)	COD.	Note
1.0	OC + RA 4 0TPP				1170		
2.1	OC 40TPP	9,7	18,0	4,6	800	IOCP10190635	
2.2	RA R40	10,8	17,7	1,1	370	IRAN11181230	