

**OCCHIELLI SERIE « TM » – « TM » EYELETS – OEILLETS « TM »**



**NOVITÀ**



Edizione 2020

**BREVETTO ITALIANO – ITALIAN PATENT – BREVET ITALIEN:  
 MI2014A 1348**

**BREVETTO EUROPEO – EUROPEAN PATENT – BREVET EUROPEEN:  
 2976960 EP**

**Composizione articoli / item composition**

- |     |  |
|-----|--|
| 1.0 | Occhiello + rondella / Eyelet + washer<br>Oeillet + Rondella (OC+RA) |
| 2.1 | Occhiello / eyelet / Oeillet<br>(OC)                                 |
| 2.2 | Rondella / washer / Rondelle<br>(RA)                                 |

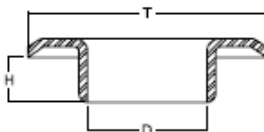

2.1

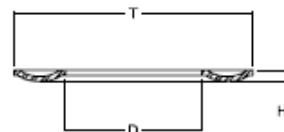

2.2

**DIMENSIONI / SIZES / DIMENSIONS:** mm

**PESO / WEIGHT / POIDS:** gr / 1000 pcs ("W" indica il peso nominale, il peso reale può essere differente / "W" stays for the standard weight; the real weight can be different / «W» indique le poids nominal, le poids réel peut être différent.

**MATERIALE / MATERIAL / MATERIAL:** Ottone – brass – laiton (Pb < 90ppm)

## OCCHIELLI SERIE « TM » – « TM » EYELETS – OEILLETS « TM »

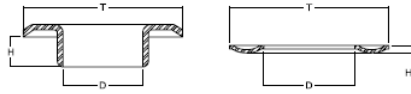

1.0 Occhiello + rondella / Eyelet + washer /  
 Oeillet + rondelle (OC+RA)

2.1 Occhiello / eyelet / oeillet (OC)

2.2 Rondella / Washer / Rondelle (RA)

		D (mm)	T (mm)	H (mm)	W (g)	COD.	Note
1.0	OC+RA VL230TM				530	OVMN05100630	
2.1	OC VL230TM	5,0	10,3	4,2	410	OOCM05100630	
2.2	RA R1130	5,0	9,5	0,8	120	ORAN06100825	
2.3	RONDELLA PLASTICA 10 x 6	6,0	10,0	1,0		PRAN061010	RONDELLA IN PLASTICA SOTTO-TESTA

		D (mm)	T (mm)	H (mm)	W (g)	COD.	Note
1.0	OC+RA VL240TM				810	OVMN06120730	
2.1	OC VL240TM	6,0	11,7	4,1	620	OOCM06120730	
2.2	RA R1140	6,8	11,8	0,8	190	ORAN07120825	
2.3	RONDELLA PLASTICA 9 x 7	7,0	9,0	1,0		PRAN070910	RONDELLA IN PLASTICA SOTTO-TESTA

		D (mm)	T (mm)	H (mm)	W (g)	COD.	Note
1.0	OC+RA VL30TM				970	OVMN08150630	
2.1	OC VL30TM	8,0	15,3	4,5	730	OOCM08150630	
2.2	RA R30 FG	9,0	14,5	0,8	240	ORAN10150830	
2.3	RONDELLA PLASTICA 15 x 10	10,0	15,0	1,0		PRAN11510	RONDELLA IN PLASTICA SOTTO-TESTA

		D (mm)	T (mm)	H (mm)	W (g)	COD.	Note
1.0	OC+RA VL40TM				1390	OVMN10180730	
2.1	OC VL40TM	9,6	18,0	4,8	1020	OOCM10180730	
2.2	RA R40	10,8	17,7	1,1	370	ORAN11181230	
2.3	RONDELLA PLASTICA 17 x 11	11,0	17,0	1,0		PRAN111710	RONDELLA IN PLASTICA SOTTO-TESTA

		D (mm)	T (mm)	H (mm)	W (g)	COD.	Note
1.0	OC+RA VL50TM				1750	OVMN12200730	<b>NOVITÀ</b>
2.1	OC VL50TM	12,1	20,0	4,0	1220	OOCM12200730	
2.2	RA R50	13,5	21,8	1,0	530	ORAN14221225	
2.3	RONDELLA PLASTICA 18 X 13	13,0	18,0	1,0			RONDELLA IN PLASTICA SOTTO-TESTA

**OCCHIELLI SERIE « TM » – « TM » EYELETS – OEILLETS « TM »**

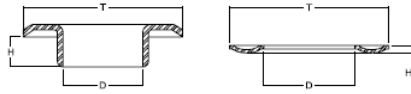

1.0 Occhiello + rondella / Eyelet + washer / Oeillet + rondelle (OC+RA)

2.1 Occhiello / eyelet / oeillet (OC)

2.2 Rondella / Washer / Rondelle (RA)

		D (mm)	T (mm)	H (mm)	W (g)	COD.	Note
1.0	OC+RA VL60TM				2080	OVMN14230730	<b>NOVITÀ</b>
2.1	OC VL60TM	14,0	23,1	4,2	1480	OOCM14230730	
2.2	RA R60	15,7	23,9	1,3	600	ORAN16241425	
2.3	RONDELLA IN PLASTICA 23X15	15,0	23,0	1,0		PRAN152310	RONDELLA IN PLASTICA SOTTO-TESTA

		D (mm)	T (mm)	H (mm)	W (g)	COD.	Note
1.0	OC+RA VL80TM				5060	OVMN18300940	<b>NOVITÀ</b>
2.1	OC VL80TM	18,1	30,6	4,1	3760	OOCM18300940	
2.2	RA R80 BP	19,3	29,0	1,4	1300	ORAN19291930	
2.3	RONDELLA IN PLASTICA 28 X 21	21,0	28,0	1,0			RONDELLA IN PLASTICA SOTTO-TESTA

SU RICHIESTA QUESTO OCCHIELLO PUO' ESSERE FORNITO CON LE RONDELLE PIATTE EFFETTO "DOUBLE FACE";

ON YOUR REQUEST, THIS EYELET CAN BE SUPPLIED WITH A FLAT "DOUBLE FACE" WASHER;

SUR DEMANDE, CET OEILLET PEUT ETRE LIVRE' AVEC UNE RONDELLE PLATTE « DOUBLE FACE ».

