

**OCCHIELLI STANDARD INOX AISI 304 – STANDARD AISI 304 INOX EYELETS  
 OEILLETTS STANDARD INOX AISI 304**



Edizione 2020

**Composizione articoli / item composition**

1.0	Occhiello + rondella / Eyelet + washer Oeillet + Rondella (OC+RA)
2.1	Occhiello / eyelet / Oeillet (OC)
2.2	Rondella / washer / Rondelle (RA)

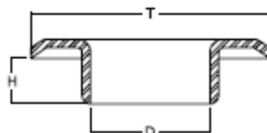

2.1



2.2

**DIMENSIONI / SIZES / DIMENSIONS:** mm

**PESO / WEIGHT / POIDS:** gr / 1000 pcs ("W" indica il peso nominale, il peso reale può essere differente / "W" stays for the standard weight; the real weight can be different / «W» indique le poids nominal, le poids réel peut être différent.

**MATERIALE / MATERIAL / MATERIAL:** inox aisi 304 – stainless steel aisi 304 – acier inoxydable aisi 304

su richiesta AISI 316 – On request AISI 316 – Sur demande AISI 316

**OCCHIELLI STANDARD INOX AISI 304 – STANDARD AISI 304 INOX EYELETS-  
 OEILLETTS STANDARD INOX AISI 304**

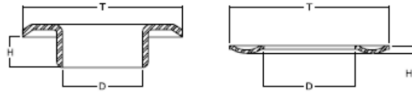

1.0 Occhiello + rondella / Eyelet + washer /  
 Oeillet + rondelle (OC+RA)

2.1 Occhiello / eyelet / oeillet (OC)

2.2 Rondella / Washer / Rondelle (RA)

		D (mm)	T (mm)	H (mm)	W (g)	COD.	Note
1.0	OC + RA VL30				800	IVSN08150630	
2.1	OC VL30	8,0	15,0	4,6	540	IOCS08150630	
2.2	RA R30FG	9,0	14,5	1,0	260	IRAN10150830	

		D (mm)	T (mm)	H (mm)	W (g)	COD.	Note
1.0	OC + RA VL40				1190	IVSN09180730	
2.1	OC VL40	9,0	18,0	6,2	860	IOCS09180730	
2.2	RA R40	10,8	17,7	1,1	330	IRAN11181230	

		D (mm)	T (mm)	H (mm)	W (g)	COD.	Note
1.0	OC + RA VL50				1570	IVSN12220930	
2.1	OC VL50	12,0	21,8	6,0	1100	IOCS12220930	
2.2	RA R50	13,5	21,8	1,0	470	IRAN14221430	

		D (mm)	T (mm)	H (mm)	W (g)	COD.	Note
1.0					1800		
2.1	OC VL60	13,8	23,6	6,3	1200	IOCS14140730	
2.2	RA R60	15,7	23,9	1,3	600	ORAN16241425	

		D (mm)	T (mm)	H (mm)	W (g)	COD.	Note
1.0					3950		
2.1	OC VL70	15,0	25,0	6,8	2450	IOCS15290940	
2.2	RA R70	17,3	29	1,5	1500	ORAN18291940	